



Częstochowa, dn. 16.03.2012 r.

The answer to inquiry of the SETC and change the SETC with the change of the date of submission offers

Dear Madam / Sir,

We kindly inform that on 16.3.2012 we have received from one Offerent a question in order to clarify the provisions of the SETC about of the inquiry for: the delivery of elements to build a furnace to thermomagnetic treatment, no. 0305/MS/2012 inquiry.

Content of question:

“Dear Sirs,

in relation to your inquiry no. 0305/MS/2012 dated 05.03.2012 "Parts for construction of a furnace for thermomagnetic

treatment" we have some question concerning drawing in Fig. 1, which seems to be incorrect.

The inner dimension of the furnace chamber from drawing in Fig. 1 is not the same as in table "Technical data". Your explanation is needed.

Thank you for your reply in advance.“

Reply to the question:

„In response to an inquiry we sending to you corrected drawing and technical data table.“



Projekt pt. „Badania przemysłowe modułów pomiarowych rzeczywistego zużycia energii elektrycznej”
współfinansowany ze środków Europejskiego Funduszu Rozwoju Regionalnego
w ramach Programu Operacyjnego Innowacyjna Gospodarka
Nr umowy: UDA-POIG.01.04.00-24-006/11-00

FURNACE FOR THERMOMAGNETIC TREATMENT

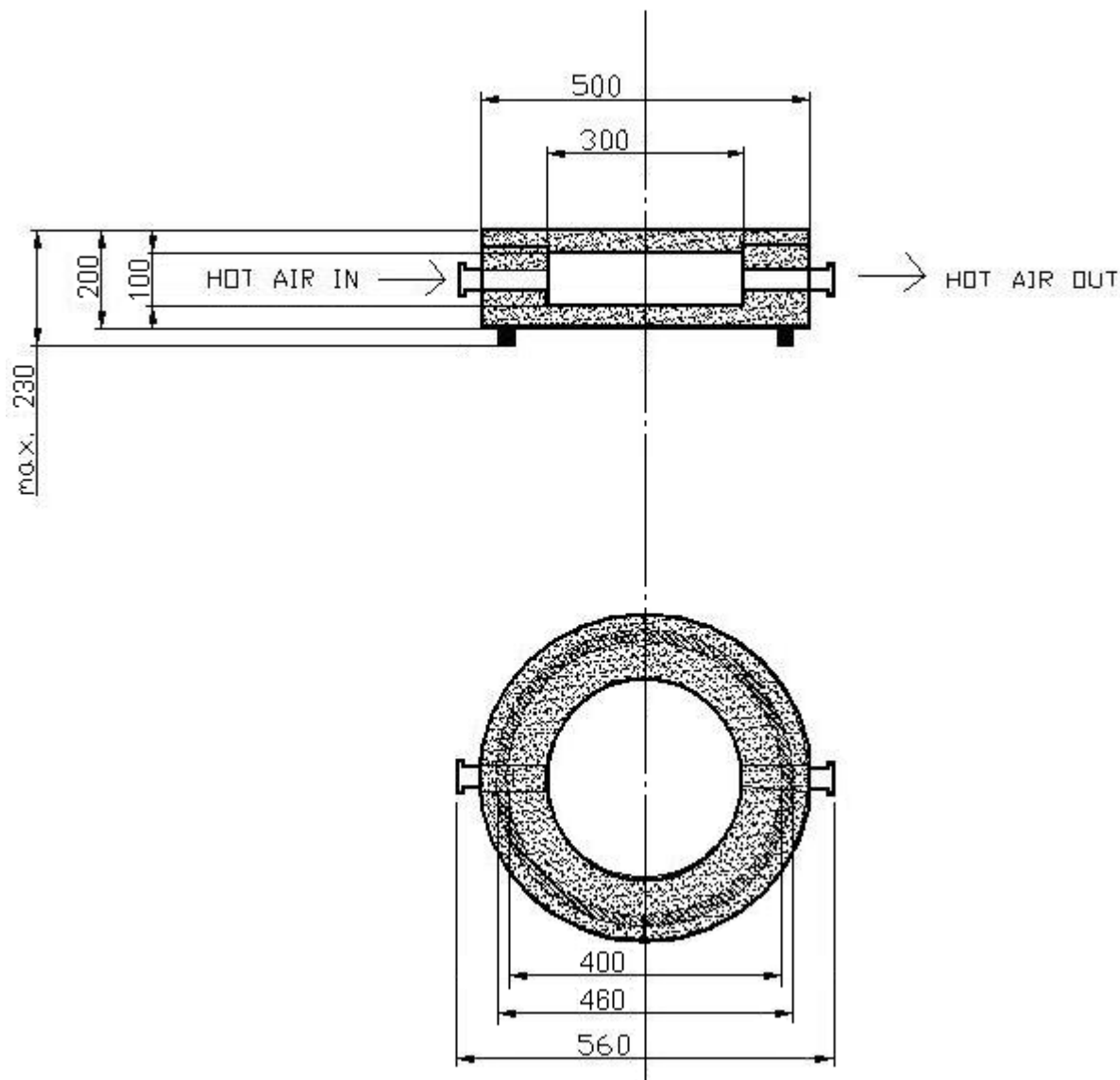

Fig. 1. Cross-section of the furnace together with the platform

TECHNICAL SPECIFICATION

Lp.	Parameter	Value
1	Max. temperature	650 ⁰ C
2	Min. chamber dimensions	φ300 x 100mm
3	Usable volume dimensions	φ300 x 80mm
4	Outer dimensions of furnace	according to drawing
5	Position of the furnace	base according to drawing
6	Max. power	20kVA



Projekt pt. „Badania przemysłowe modułów pomiarowych rzeczywistego zużycia energii elektrycznej”
współfinansowany ze środków Europejskiego Funduszu Rozwoju Regionalnego
w ramach Programu Operacyjnego Innowacyjna Gospodarka
Nr umowy: UDA-POIG.01.04.00-24-006/11-00

7	Power supply	400 V, 50Hz
8	Temperature control	JUMO IMAGO500
9	Thermocouples	3 x typ „K”
10	Repeatable control accuracy	$\pm 1^{\circ}\text{C}$
11	The protective atmosphere	N2 and Ar
12	Method of charging	top of the furnace
13	Maximum weight of the charge	40kg
14	Heating system	External
15	The material used for the implementation of the furnace cover	Non magnetic stainless steel
16	The material used for the implementation of the base	Non magnetic stainless steel

Due to modification of the SETC documentation, Purchaser makes changes in the dates of inquiry, i.e.:

- we extend deadline for submission of offers until **26.3.2012** (inquiry item 3),
- we change term to **27.03.2012**, when final decision will taken (inquiry item 4).

Yours sincerely

Marian Soiński